

## 1989 REPAIR MANUAL

Shimano American Corporation, One Shimano Dr.  
Irvine, CA 92718

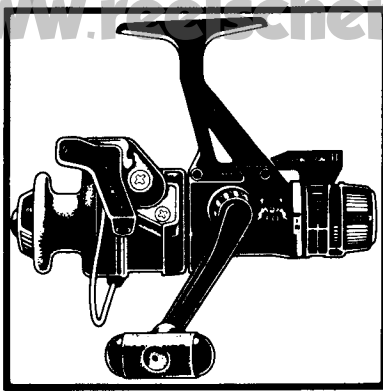

### EXPLODED PARTS VIEW

*Black Magnum SBK 1000 Q*

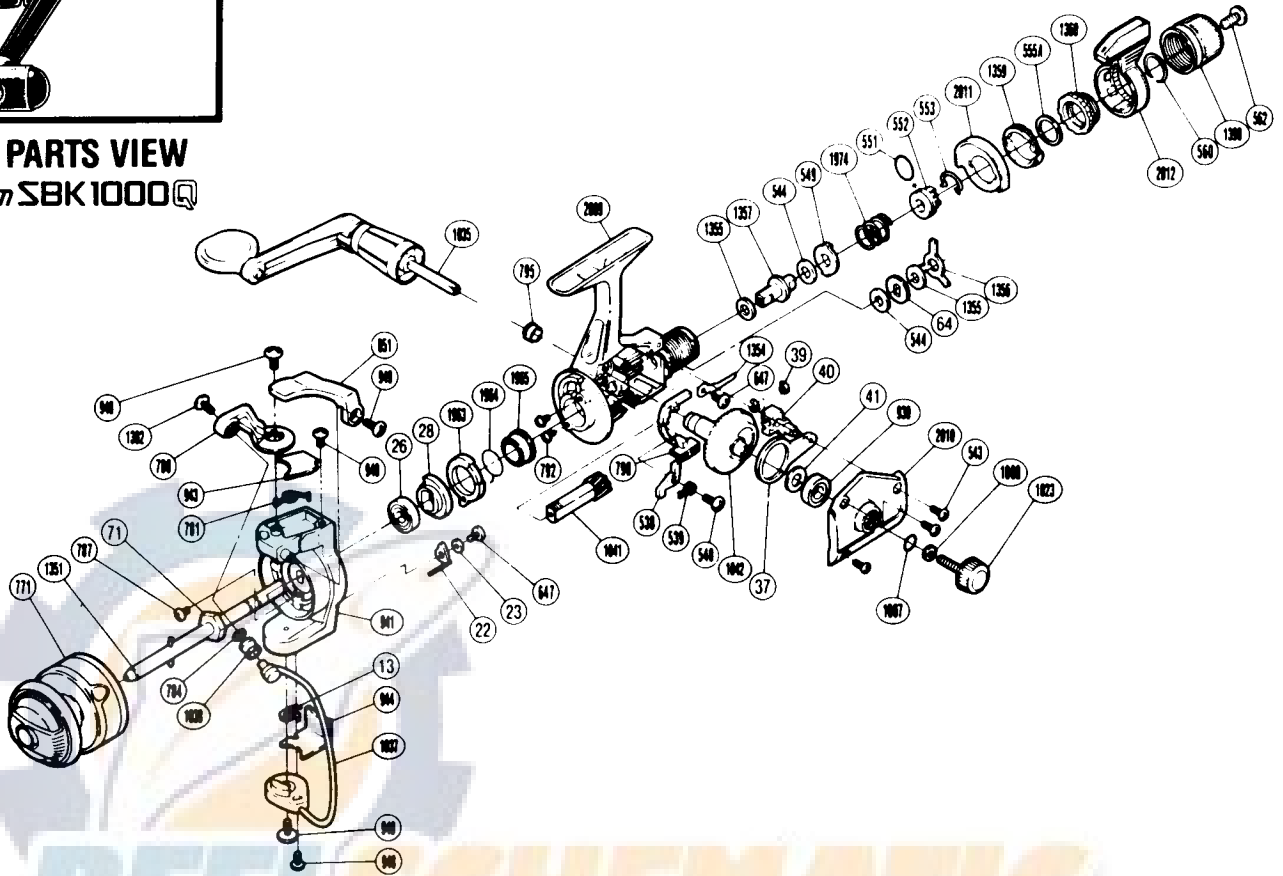

### PARTS LIST

**PART # DESCRIPTION**

- RD 0013 (Trip) Lever Spring
- RD 0022 (Bail) Trip Lever
- RD 0023 Trip Lever Spacer
- RD 0026 Ball Bearing
- RD 0028 Anti-Reverse Ratchet
- RD 0037 Oscillating Arm
- RD 0039 "C" Lock
- RD 0040 Oscillating Block
- RD 0041 Drive Gear Washer
- RD 0064 Click Gear
- RD 0071 Rotor Nut
- RD 0538 Anti-Reverse Pawl
- RD 0539 Anti-Reverse Pawl Spring
- RD 0540 Anti-Reverse Pawl Screw
- RD 0543 Side Cover Screw (B)
- RD 0544 Drag Washer "C2" (White)
- RD 0549 Eared Washer "B"
- RD 0551 "O" Ring
- RD 0552 Pressure Screw
- RD 0553 Hold Click Spring
- RD 0555A Fightin' Pressure Screw Washer

**PART # DESCRIPTION**

- RD 0560 Lever Hold Spring
- RD 0562 Drag Programmer Screw
- RD 0647 Nut Lock Screw
- RD 0771 Spool Assembly
- RD 0780 Bail Arm
- RD 0781 Bail Spring
- RD 0784 Line Roller Washer
- RD 0787 Nut Lock Screw
- RD 0790 Anti-Reverse Switch (Black)
- RD 0792 Bearing Retainer Screw
- RD 0795 Bushing B
- RD 0851 Quick-Fire II Trigger
- RD 0930 Ball Bearing
- RD 0940 Bail Trip Cam Screw
- RD 0941 Rotor
- RD 0943 Bail Spring Cover
- RD 0944 Bail Trip Cover
- RD 0948 Bail Trip Cover Screw
- RD 0949 Trigger Screw
- RD 1007 Lock Washer Retainer
- RD 1008 Handle Lock Washer
- RD 1023 Handle Screw Cap

**PART # DESCRIPTION**

- RD 1035 Handle Assembly
- RD 1037 Bail Assembly
- RD 1038 Sic Ceramic Roller
- RD 1041 Pinion Gear
- RD 1042 Drive Gear
- RD 1302 Line Roller Screw
- RD 1351 Main Shaft
- RD 1354 Drag Click
- RD 1355 Drag Washer "C1"
- RD 1356 Eared Washer "BF"
- RD 1357 Drag Shaft
- RD 1359 Lever Click Gear
- RD 1360 Fightin' Pressure Screw
- RD 1398 Drag Programmer
- RD 1963 Anti-Reverse Lock Out
- RD 1964 Anti-Reverse Lock Out Spring
- RD 1965 Pinion Spacer
- RD 1974 Drag Coil Spring
- RD 2009 Body
- RD 2010 Side Cover
- RD 2011 Lever Quadrant
- RD 2012 Fightin' Drag II Lever